

THIS DETAIL APPLIES TO METAL TRAPEZOID ROOF PROFILES WITH ROOFPITCHES BETWEEN 15 AND 60 DEGREES.

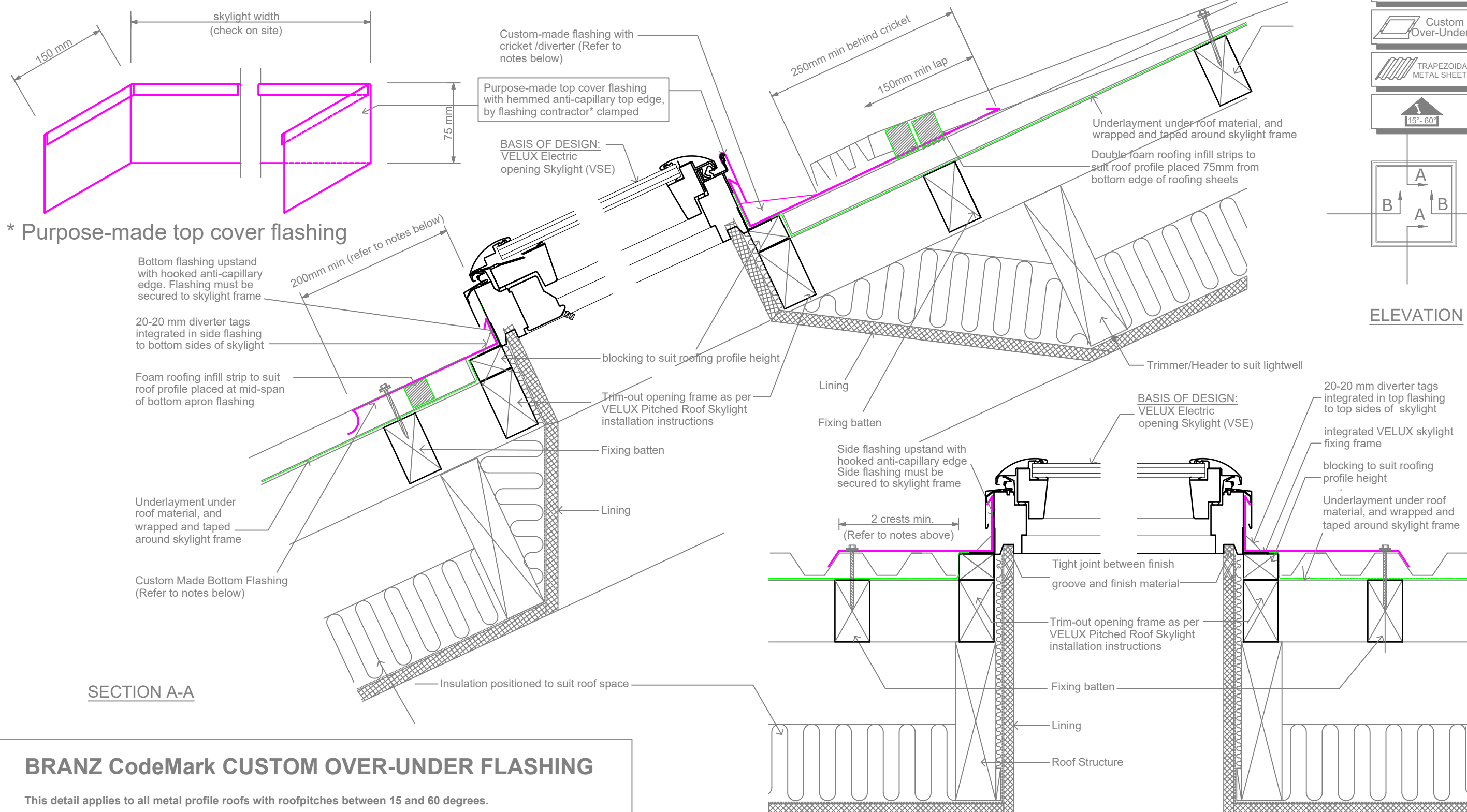

SECTION A-A

SECTION B-B

BRANZ CodeMark CUSTOM OVER-UNDER FLASHING

This detail applies to all metal profile roofs with roof pitches between 15 and 60 degrees.

No cricket or diverter required when skylight is less than 600mm wide, and catchment less than 40 sqm.

Custom flashings must be designed to meet the requirements set out in the latest version of the New Zealand Metal Roof and Wall Cladding Code of Practice, and shall be manufactured and installed by a specialist flashing contractor to the latest trade practices.

For roofs with roof pitches less than 15 degrees, the VELUX Skylight must be installed to a min.15 degrees.

The flashing and installation must be guaranteed against weathertightness by the specialist flashing contractor. Insulation material meeting the requirements of NZBC/H1 is required in the cavities of the lightwell structure.

VELUX

Sky-Product Management

NEW ZEALAND LTD.

0800 650 445

VELUX VSE electric skylights with custom-made over-under flashing for Trapezoid Metal Roofs with roof pitch 15-60 degrees

| Name | Date |
|-------------|--------|
| Drawn by | Jul 24 |
| Checked by | Jul 24 |
| Drawing No. | |